

IROAD™

IROAD **OBD POWER CABLE**
Quick Start

Ver 1.0 (JUN. 2024)

PRECAUTIONS

- ※ Do not arbitrarily disassemble or modify the product
Malfunction or breakdown may occur
- ※ Be careful of any damages on the power cable and cord.
Do not use damaged or modified power cables
- ※ Please only use IROAD dash cam. It may cause defects when used with other products.
- ※ Before using, make sure that eh cables are connected correctly.
Wrong connection may cause malfunctioning.
- ※ While driving, do not use/attempt to connect to the device as it may cause accidents to occur.
- ※ Do not excessively shock the product as it may cause malfunctioning.
- ※ Do not expose to flame as it may cause an explosion or fire.
- ※ Do not cover the product with cloth or other materials as it may cause fire or breakdown.
- ※ Ensure that it is operating normally before driving.

WARRANTY

PRODUCT NAME		
SERIAL NUMBER		
DATE OF PURCHASE		
SUPPLIER	SHOP NAME	
	CONTACT NUMBER	

- Thanks for purchasing IROAD OBD Power Cable.
IROAD carries out product quality assurance as follows.
- This product was developed through rigorous quality control and various inspection processes.
Generic faults within the warranty period will be replaced free of charge.
Additional repair cost will be charged if the warranty period is expired.
- If the warranty period has expired, or if the following conditions will be charged even within the warranty period.
Breakdown due to natural disaster such as lighting, storm, flood and so on
Failure due to user's carelessness such as drop, wet, shock and so on
Failure due to power supply or faulty connecting device / If the product is modified or has been repaired elsewhere
Failure due to use of parts other than IROAD's designated parts
- How to refund.
Refund or exchange is available within 14 days of purchase (At the place of purchase)
We can issue a refund or exchange if there is a technical problem,
or if there was a misrepresentation in the product description.
We cannot accept exchange or return of previously assembled, open packaging or damaged items.
- Warranty period of each part is as follows.
OBD Power Cable : 6 Months

SPECIFICATIONS

Model	OBD IM-300
Input	DC 12~24V
Output	DC 12~24V
Output Current	Max 2A
Operating Temperature	-40 ~ 85° C
Overcurrent Shutdown	Min 3.4A

FEATURE

- Built-in Switch to control vehicle type & recording mode
- Built-in Electronic fuse for increased safety.
- Built-in low-voltage protection feature to prevent vehicle battery discharging
- Supports Stop & Go vehicles
- Supports 12~24V vehicle with an OBD-II port (all vehicles manufactured after 1996)

COMPONENTS

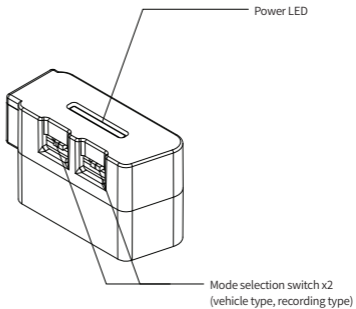
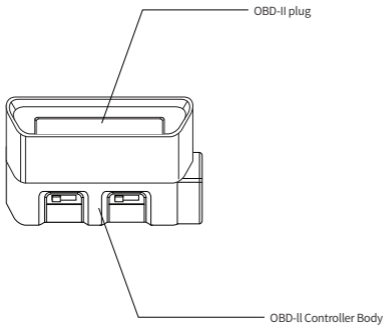

HOW TO USE

FIND YOUR OBD-II PORT

The OBD-II port is usually located underneath the dashboard on the driver's side, often within 2 feet of the steering wheel.

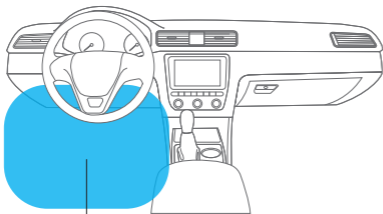

OBD-II Port Locations
The most common locations for the port.

INSTALLING THE DEVICE

1

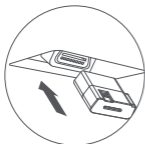

Now that you've found your OBD-II port, align and plug the device connector.

2



Install the OBD-II power cable around the trim of your vehicle.

3

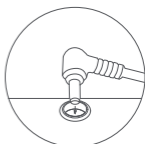

Connect OBD-II cable to the dash cam.

• **Note:** OBD-II switch setting (Parking mode ON "P" / Parking mode OFF "S")

THE LEADING DASHCAM BRAND | **IROAD**

Model : OBD IM-300

Product : OBD POWER CABLE

Verification Number : R-R-JWW-IM300

IROAD MOBILITY Co., Ltd

Made in Korea



I IROAD MOBILITY CO., LTD. **HEAD QUARTERS**
www.iroad.kr

I CORVIT INTERNATIONAL **SINGAPORE**
www.iroad.sg

I POSIS **HONG KONG**
www.iroad.hk

I IROAD MALAYSIA **MALAYSIA**
www.iroad.my